

Split Phase Inverter Charger

Reliable Power Solution

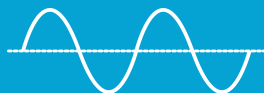

The COSUPER DPT series inverter is a low frequency, pure sine wave inverter line made for handling 120VAC/240VAC split phase applications. Specifically designed for North America and the area which asks 120VAC/240VAC dual output power supply.

With the rapid-raley-switching system, this inverter can work with the battery and utility grid as the Uninterrupted Power System to provide continuous energy supply. This smart inverter charger is also able to work with Lithium Battery by RS485 communication to realize the optimized energy management.

DPT series inverter charger is heavy duty, powerfully, easy-to-use and the best of all, cost effective.

Features

- RS485 communication equipped
- Low THD ensure sensitive loads working stably
- MAX. 80A charge current for AGM/GEL/Flooded/Lithium batteries
- Heavy duty design for motored loads
- High working temperature tolerance for -10~50°C at 100% continuous output
- Battery temperature compensation for energizing battery in cold environment ; Control battery in safe charge regulation in high temperature
- Ultra-low idle consumption to save energy
- Auto GEN start/stop

Protection

- AC input/output over current
- AC input over/low voltage
- Battery over/low voltage
- Output overload
- Output short circuit
- Over temperature

Application



Off Grid System



Mobile House

Power Range

4000W

5000W

6000W

8000W

10KW

12KW

COSUPER (SUZHOU) ENERGY TECHNOLOGY CO.,LTD

#18 building
NO.99, Gangtian Road
Suzhou, Jiangsu Province, China
Tel: 0086 512 68638910
Fax: 0086 512 68638916

www.cosuper.com

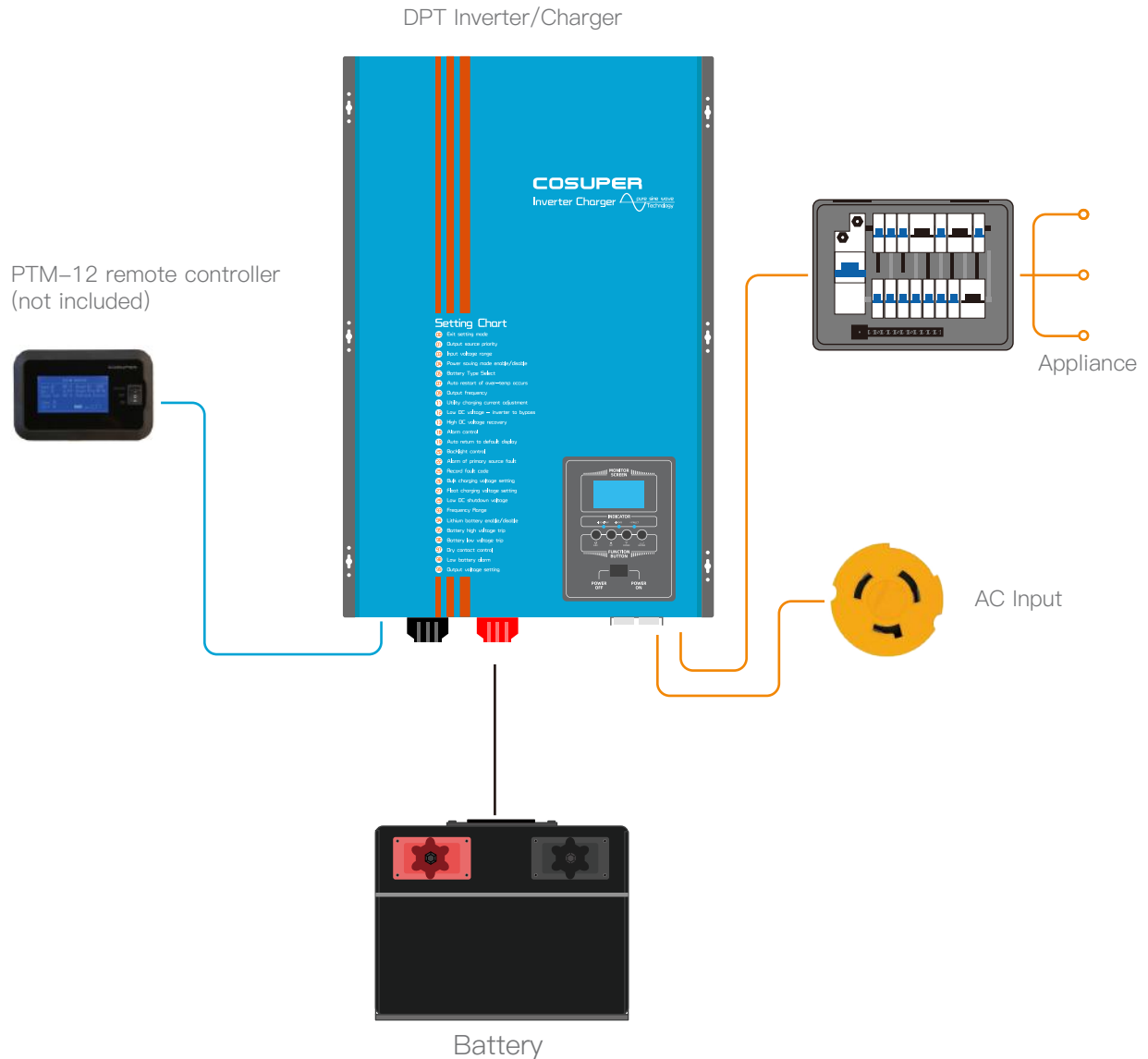

Working Mode

>> Utility Mode, with AC input, inverter ON

With shore or Gen connected, inverter is ON.

Inverter bypass to AC loads by Shore/Gen, no more discharge battery. At the same time give charge to both start battery @3~5Adc and house battery @Max. 80Adc.

>> Off Grid Mode, no AC input, inverter ON

Without AC input, inverter is ON.

Inverter convert DC power from battery to be AC power, to provide stable AC power to appliance in vehicle. Can work at -10~50°C environment continuously without power loss.

DPT Series

INVERTER/CHARGER

COSUPER
Cool life Super power

| | DPT4000 | DPT5000 | DPT6000 |
|------------------------------|--|-----------------------|-----------------------|
| Rated Power (-10~50°C) | 4000 W | 5000 W | 6000 W |
| DC Input | | | |
| Rated Voltage | 24VDC (20.0~32.0VDC); x2 for 48VDC | | |
| Max. Charge Current | 60A-house battery; | 75A-house battery; | 80A-house battery; |
| Battery Type | AGM/Gel/Flooded/Lithium | | |
| AC Input | | | |
| Voltage Range | 170-275VAC | 170-275VAC | 170-275VAC |
| Input Frequency | 45-65Hz | 45-65Hz | 45-65Hz |
| AC Output | | | |
| Output Voltage | 120/240VAC±5% | 120V/240VAC±5% | 120V/240VAC±5% |
| Output Frequency | 60/50Hz±0.3 | 60/50Hz±0.3 | 60/50Hz±0.3 |
| Waveform | Pure sine wave | Pure sine wave | Pure sine wave |
| Switch Time | <8ms | <8ms | <8ms |
| Efficiency | >88% | >88% | >88% |
| Overload | 105~120% 10s/ >120% 3s/ >150% 1s | | |
| Max. Bypass | 6000W | 7200W | 8000W |
| Protection | DC over/low volt, AC input low/over volt, AC short circuit, overtemp, overload | | |
| Self-consumption | 35.0W | 50.0W | 55.0W |
| Idle-consumption | 23.5W | 23.5W | 25.0W |
| Protection | | | |
| DC low-volt alarm/shutdown | 21.0V (Customizable at Engineering mode); x2 for 48VDC | | |
| AC low-volt switch to DC | 187.0V (Customizable at Engineering mode) | | |
| Bypass to Inverting | 198.0V (Customizable at Engineering mode) | | |
| Battery over-charge shutdown | 31.4V | 31.4V | 31.4V |
| General | | | |
| Working Temperature | -10~45°C | -10~45°C | -10~45°C |
| Storage Temperature | -20~55°C | -20~55°C | -20~55°C |
| Work/Storage Humidity | 0-90% No condensation | 0-90% No condensation | 0-90% No condensation |
| Dimension (W*D*H) | 607*308*198 mm | 607*308*198 mm | 607*308*198 mm |

| | DPT8K | DPT10K | DPT12K |
|------------------------------|--|----------------------|----------------------|
| Rated Power (-10~50°C) | 8000 W | 10000 W | 12000 W |
| DC Input | | | |
| Rated Voltage | 48VDC (40.0~64.0VDC) | 48VDC (40.0~64.0VDC) | 48VDC (40.0~64.0VDC) |
| Max. Charge Current | 55A-house battery; | 70A-house battery; | 80A-house battery; |
| Battery Type | AGM/Gel/Flooded/Lithium | | |
| AC Input | | | |
| Voltage Range | 170~275VAC | 170~275VAC | 170~275VAC |
| Input Frequency | 45~65Hz | 45~65Hz | 45~65Hz |
| AC Output | | | |
| Output Voltage | 120/240VAC±5% | 120V/240VAC±5% | 120V/240VAC±5% |
| Output Frequency | 60/50Hz±0.3 | 60/50Hz±0.3 | 60/50Hz±0.3 |
| Waveform | Pure sine wave | Pure sine wave | Pure sine wave |
| Switch Time | <8ms | <8ms | <8ms |
| Efficiency | >88% | >88% | >88% |
| Overload | 105~120% 10s/ >120% 3s/ >150% 1s | | |
| Max. Bypass | 10000W | 12000W | 15000W |
| Protection | DC over/low volt, AC input low/over volt, AC short circuit, overtemp, overload | | |
| Self-consumption | 55.0W | 60.0W | 60.0W |
| Idle-consumption | 23.5W | 23.5W | 25.0W |
| Protection | | | |
| DC low-volt alarm/shutdown | 42.0V (Customizable at Engineering mode) | | |
| AC low-volt switch to DC | 187.0V (Customizable at Engineering mode) | | |
| Bypass to Inverting | 198.0V (Customizable at Engineering mode) | | |
| Battery over-charge shutdown | 62.8V | 62.8V | 62.8V |
| General | | | |
| Working Temperature | -10~45°C | -10~45°C | -10~45°C |
| Storage Temperature | -20~55°C | -20~55°C | -20~55°C |
| Work/Storage Humidity | 0~90% No condensation | | |
| Dimension (W*D*H) | 607*308*198 mm | | |